

INSTRUCTIONS

LuXout Shades Pulse Hub & App

Setup Instructions

LUXOUT
VIDEOS



About The App

The LuXout Shade Pulse app allows for control of your motorized window treatments through your smartphone/tablet.

The app allows for:

- Individual and group control
- Scene control
- Timer functionality

Getting Started

In order to control your motorized window treatments through Amazon Alexa, you will need to have:

- Purchased and set up one or more LuXout Shades Wi-Fi Hubs depending on the size of the space.
- Downloaded LuXout Automate Shades app onto your mobile device.



Instructions Included:

Set up instructions for both LuXout Shade Pulse App and Wi-Fi Hub.

LuXout Shades SPECIFICATION SUBMITTAL

Job Name:	Model Numbers:	
<input type="text"/>	<input type="text"/>	<input type="text"/>
Job Number:	<input type="text"/>	<input type="text"/>

INSTRUCTIONS

LuXout Shades Pulse Hub & App

Setup Instructions



Wi-fi Bridge Technical Specs

- Radio Frequency range: up to 60 feet (depending on obstructions)
- Radio Frequency: 433 MHz
- Wi-fi: 2.4 GHz
- Power: 120V AC
- For Indoor Use Only

Setup Considerations

- Hub must be within signal range of both the motorized window treatments and the wi-fi router.
- Wi-fi network must be visible
- Environments with multiple WAPs (wireless access points) may need to temporarily disable all but one.
- Security settings may need to be temporarily disabled.

Capabilities

- Motors per Bridge: 30
- Locations per account: 5
- Wi-fi Hubs per location: 5
- Rooms per Location: 20
- Scenes per Location: 20
- Timers per Location: 20

Box Contents



Pulse Hub



Plug



Short Cord



Long Cord

LuXout Shades SPECIFICATION SUBMITTAL

Job Name:	Model Numbers:	
<input type="text"/>	<input type="text"/>	<input type="text"/>
Job Number:	<input type="text"/>	<input type="text"/>

INSTRUCTIONS

LuXout Shades Pulse Hub & App

Setup Instructions

Unpacking The Wi-Fi Hub



1). Unpack the Wi-Fi Hub



2). Insert the USB end of the power cord (long or short) into the outlet power plug.



3). Insert the micro USB end of the power cord (long or short) into the Wi-Fi Hub.



4). Place the hub in a centrally located position in your home and plug in to outlet. (You may need to experiment with different locations to be able to reach the desired shades or add hub to cover large homes.

Setting Up The App

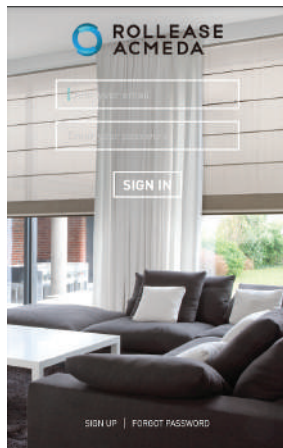

1). Open Pulse mobile application.

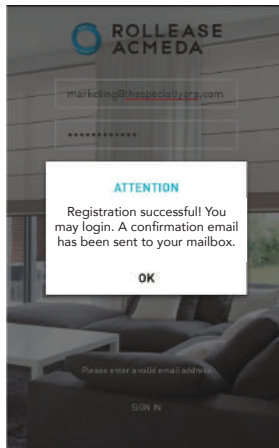

2). If required, create a new account. Select Sign Up on the bottom left corner of the screen. Creating an account will require an email address & password.

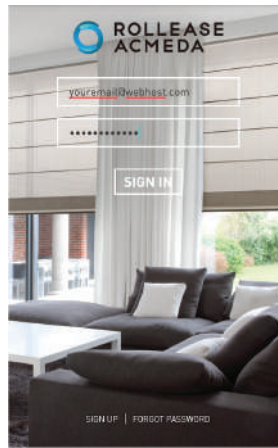

3). Sign in with your account information.

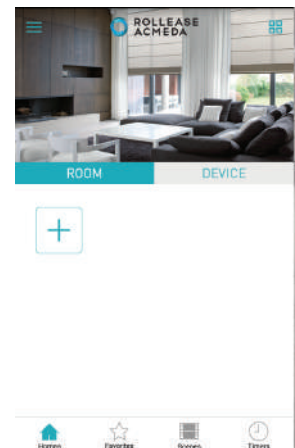

4). Link the application to the new Wi-Fi Hub. Select the menu button in the upper left corner of the home screen (3 horizontal lines)

LuXout Shades SPECIFICATION SUBMITTAL

Job Name:	Model Numbers:	
<input type="text"/>	<input type="text"/>	<input type="text"/>
Job Number:	<input type="text"/>	<input type="text"/>

INSTRUCTIONS

LuXout Shades Pulse Hub & App

Setup Instructions

Setting Up The App

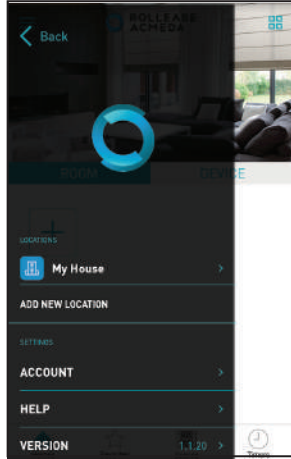

5). Select the default "Home" option under LOCATION to open Location Settings.

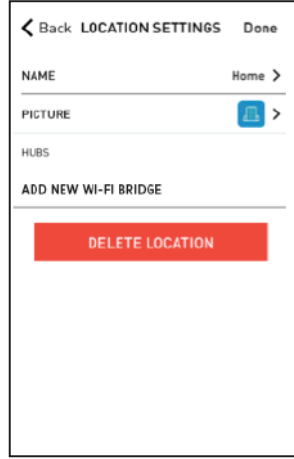

6). Select "ADD NEW WI-FI BRIDGE" to enter the pairing process.

Pairing The App & Wi-Fi Hub

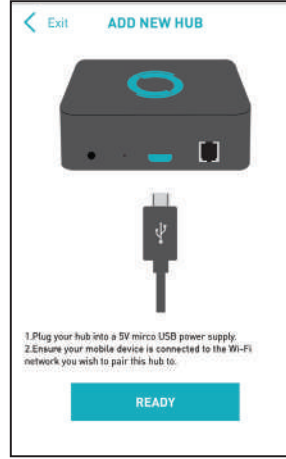

7). Follow on screen instructions to pair the new Wi-Fi Hub to the application. Ensure Wi-Fi Hub is plugged in. Select "Ready".

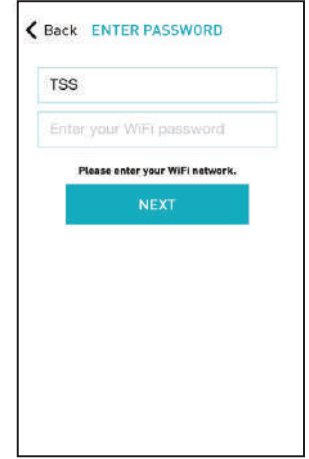

8). SSID will populate based on the current network your device is connected to. Enter your Wi-Fi password. Select "Next".

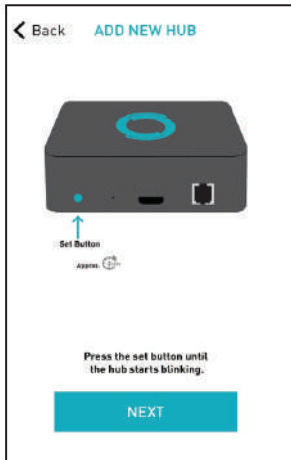

9). Hold the Wi-Fi Hub set button for 2 seconds. The hub will start blinking blue to signify it is ready to pair to the network. Select "Matching".

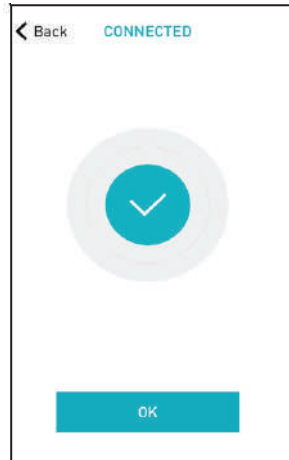

10). The Wi-Fi Hub will attempt to pair to your Wi-Fi network for 60 seconds. Select "OK" after success.

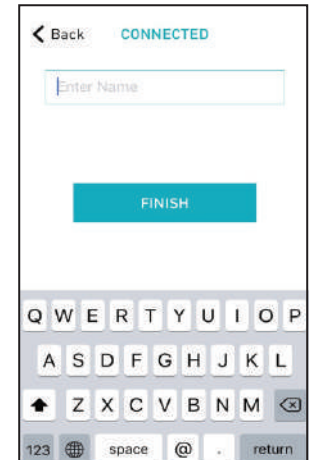

11). Name your Wi-Fi Hub to complete the Wi-Fi connection process.

LuXout Shades SPECIFICATION SUBMITTAL

Job Name:	Model Numbers:	
<input type="text"/>	<input type="text"/>	<input type="text"/>
Job Number:	<input type="text"/>	<input type="text"/>

INSTRUCTIONS

LuXout Shades Pulse Hub & App

Pairing & Linking Instructions

Pairing The App & Wi-Fi Hub

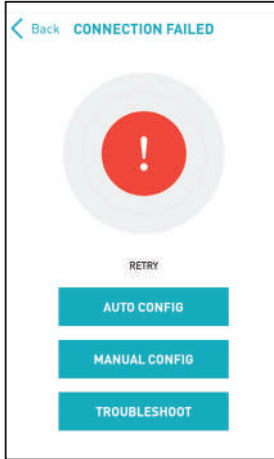

12). There are a number of factors that will influence the network pairing process. Some networks require more time to make the initial communication links with the application servers.

In the event you receive the "Connection Failed" screen, we suggest you reattempt the pairing sequence by selecting "Auto Configuration". This will redirect you to complete the above process again. If unsuccessful again you may choose the second connection path by selecting "Manual Configuration". See Manual Configuration steps below.

Manual Configuration

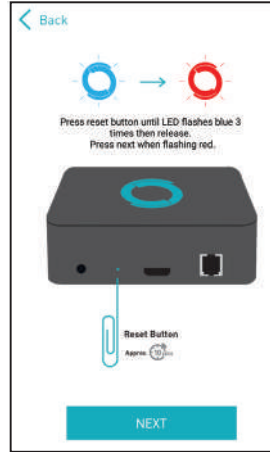

13). Using a paper clip, press and hold the recessed button on the Wi-Fi Hub until the hub blinks blue 3 times. Press next when the hub begins blinking red.

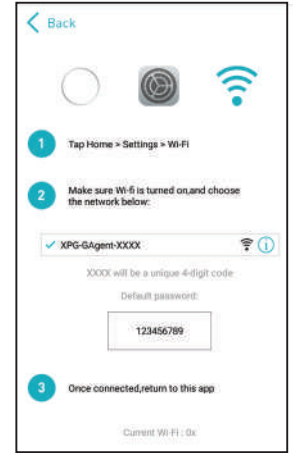

14). Using your home button exit the app and enter your Wi-Fi settings. Select the XPG-GAgent-XXXX network & enter the default password 123456789. Return to the app.

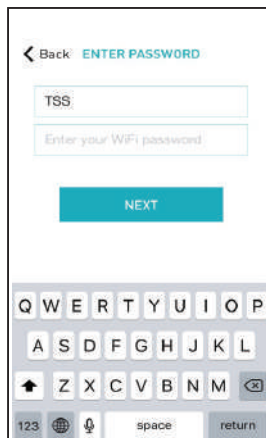

15). You will be prompted to enter the password for your Wi-Fi network. Enter your Wi-Fi password. Click next.

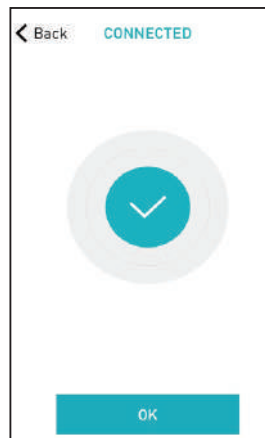

16). Your Hub should connect to your Wi-Fi network and direct you to the Connected screen. Press OK. Name your Hub and click finish to complete the Wi-Fi connection process.

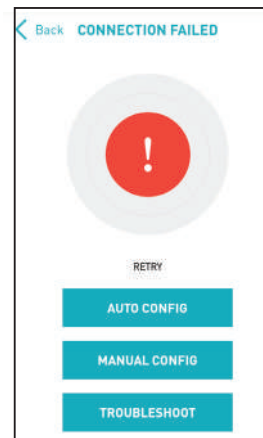

17). In the event that after the manual configuration process completes you are directed to the Connection Failed screen again. Confirm your Hub is either blinking blue/purple or has started to blink 5 times once every 5 seconds. If so, press the Troubleshoot button.

LuXout Shades SPECIFICATION SUBMITTAL

Job Name: <input style="width: 90%;" type="text"/>	Model Numbers: <input style="width: 95%;" type="text"/>
Job Number: <input style="width: 80%;" type="text"/>	<input style="width: 95%;" type="text"/>

INSTRUCTIONS

LuXout Shades Pulse Hub & App

Pairing & Linking Instructions

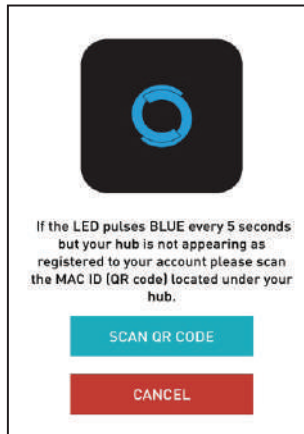

18). This will allow you to manually connect the Wi-Fi Hub to your App. Press "Scan QR Code" You must allow the app rights to use your smartphone/tablet camera when prompted.

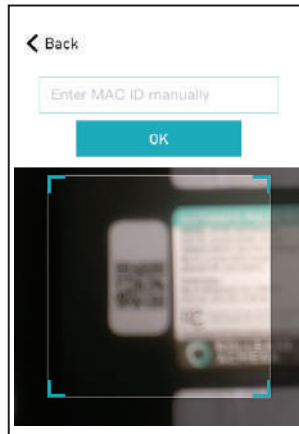

19). On the bottom of your Wi-Fi Hub there will either be a Number/Letter code or a small QR code. Use the camera to scan the QR code or manually type in the Number/Letter code and press OK.

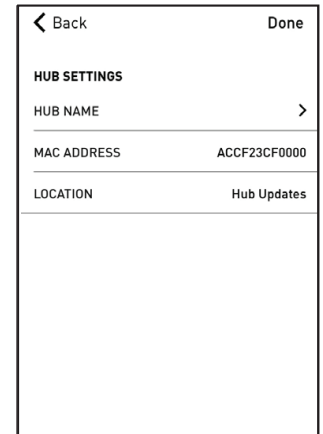

19). On the settings screen you will be prompted to name your Wi-Fi Hub. Name your Hub and press OK to complete the Wi-Fi connection process.

How To Link Each Shade To The App

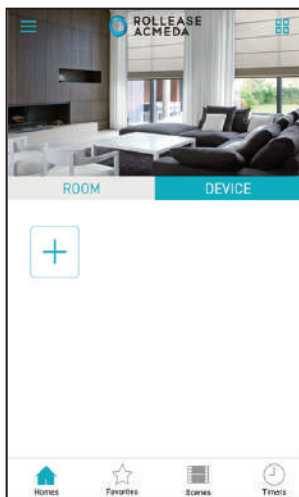

20). On the home screen select "Device" then select the "Plus" icon to add a new shade device.



21). Select from the list the hub to which you wish to pair a shade and select "Next".

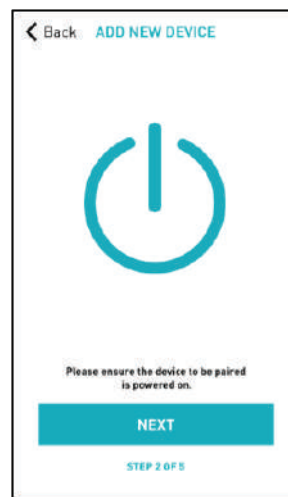

22). Make sure the shade device is plugged in or ready to be paired and select "Next".

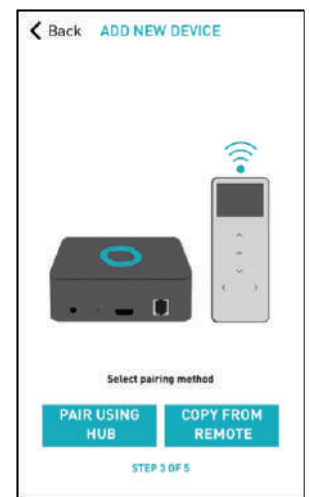

23). Choose your pairing method: "PAIR USING HUB" or "COPY FROM REMOTE".

LuXout Shades SPECIFICATION SUBMITTAL

Job Name:	Model Numbers:	
<input type="text"/>	<input type="text"/>	<input type="text"/>
Job Number:	<input type="text"/>	<input type="text"/>

INSTRUCTIONS

LuXout Shades Pulse Hub & App

Linking & Setting Instructions

How To Link Each Shade To The App



24) **Option One**
PAIR USING HUB
 (Requires access to the motor head)
 • Press and hold the "P1" button on the motor head 2 seconds. The motor will jog up and down once and you will hear one audible beep
 • Press "Pair" on the app screen "Next".
 • Press "Next" to add another

OR

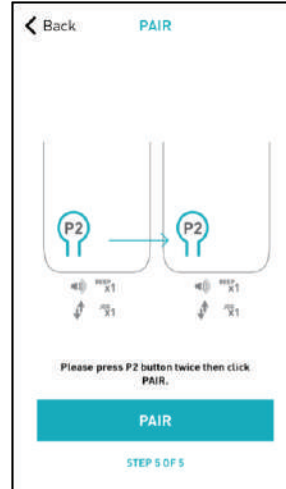

24) **Option Two**
COPY FROM CONTROLLER
 (Requires controller in hand)
 * Make sure each button on remote only controls one shade.
 • Make sure the remote is tuned to the shade's individual channel (not Ch 0).
 • Remove the remote battery cover and press the upper left P2 button next to the battery. The motor will jog up and down once and you will hear one audible beep.
 • Press the upper left P2 button again. The motor will jog up and down once and you will

hear one audible beep.
 • Press "Pair" on the app screen.
 Some controllers only have one button such as the 5 channel controller.

PAIRING COMPLETE - How To Edit Settings For Each Shade

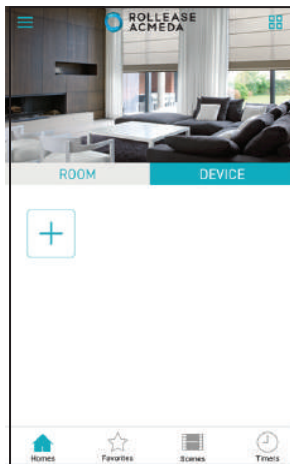

13). Select DEVICE

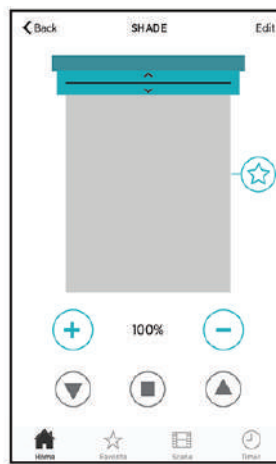

14). Select "Edit" in the upper right corner.

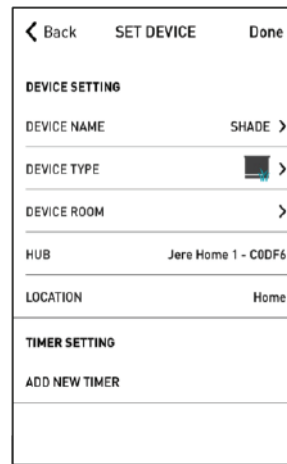

15). Modify Device Name to customize your treatment name.

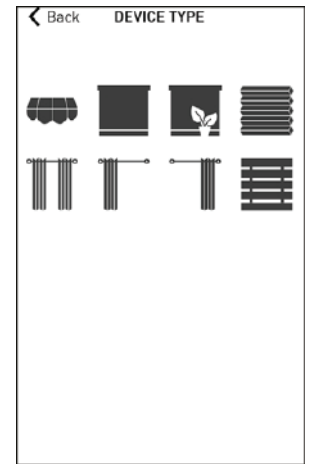

16). Modify Device Type to the representative icon of your product.

LuXout Shades SPECIFICATION SUBMITTAL

Job Name:	Model Numbers:	
<input type="text"/>	<input type="text"/>	<input type="text"/>
Job Number:	<input type="text"/>	<input type="text"/>

INSTRUCTIONS

LuXout Shades Pulse Hub & App

Setting & Scene Instructions

How To Edit Settings For Each Shade

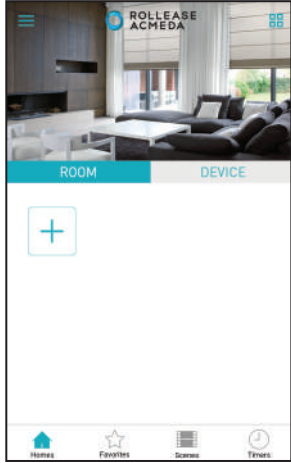

17). Once all shades are linked to the application. Select the "Plus" icon to add a new room designation, return to the home screen, select "Room".

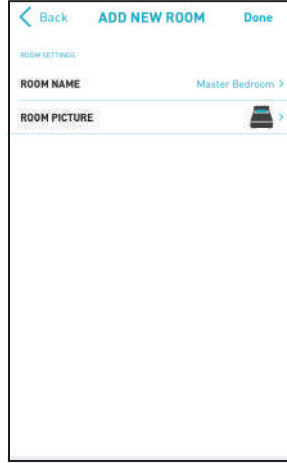

18). Name the room, pick the room icon and click "Done".

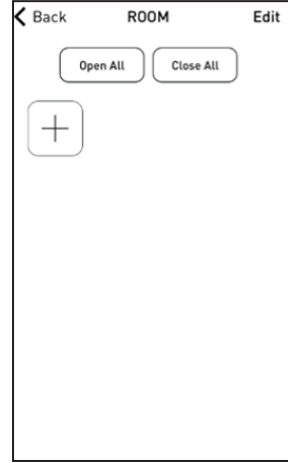

19). Select the newly created room and select the "Plus" icon to add a linked shade to the room.



20). Select "Add Existing Device" to select treatments from the dropdown to add to the room. (Choosing "Add New Device" will revert back to the pairing a new device sequence.)

Creating Scenes

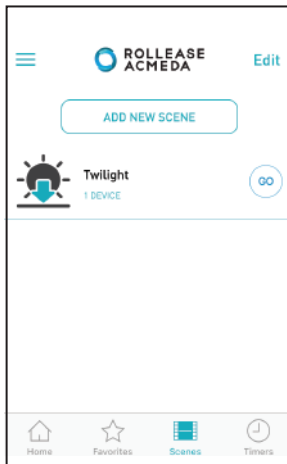

Steps A - B.

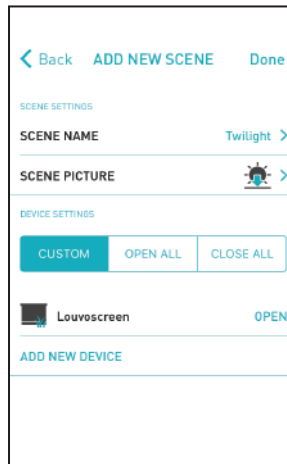

Steps C - G.

Once you have completed the pairing process for the Wi-Fi Hub and linked all of your shades to the application, you can create scenes to set a treatment or group of treatments to specific heights.

- A). On the lower menu bar select the Scene icon. This will take you to the scene homepage.
- B). Select "Add New Scene" to begin programming your desired scene.
- C). Input your scene name and select a scene picture.
- D). You can choose custom heights (by %) or set open/closed for all selected treatments. (If you select custom you must select a treatment height for each selected treatment)
- E). Select "Add New Device" to add your treatment to the scene being created.
- F). Set the treatment height percentage if necessary.
- G). Select "Done" to finalize your scene.

You can activate your custom scene by navigating to the scene menu, and pressing "GO" next to the desired scene name. If you wish to set a programmed timer to activate your scene or individual shades,

LuXout Shades SPECIFICATION SUBMITTAL

Job Name:	Model Numbers:	
<input type="text"/>	<input type="text"/>	<input type="text"/>
Job Number:	<input type="text"/>	<input type="text"/>

INSTRUCTIONS

LuXout Shades Pulse Hub & App

How To Set Timers

Setting Timers

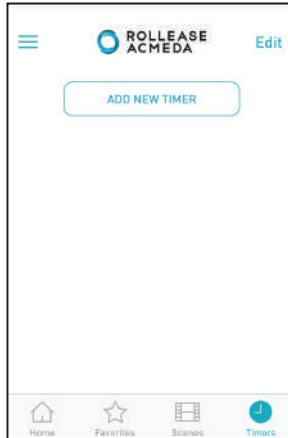

Steps A - B.

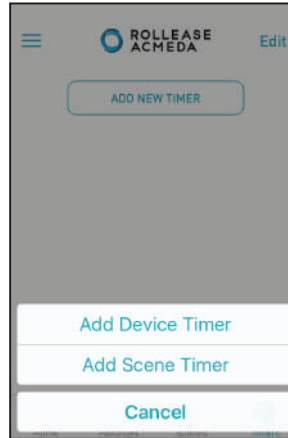

Step C.

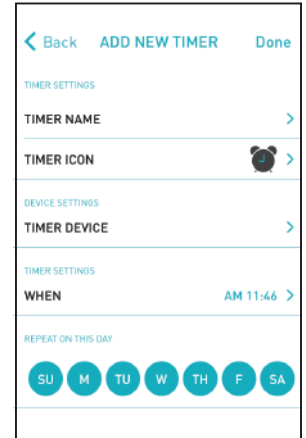

Steps D - H.

You can program timers to trigger the specific operation of your shades and scenes at your desired times throughout the day.

- A). On the lower menu bar select the Timer icon. This will take you to the Timer homepage.
- B). Select "Add New Timer" to begin programming your desired timer.
- C). Select either "Add Device Timer" or "Add Scene Timer"
- D). Input your timer name and select a timer picture.
- E). Add the devices or scenes you wish to operate.
- F). Set the time you wish the timer to trigger shade control.
- G). Select the days you wish the timer to operate. (Black dot signifies the timer will repeat on that day)
- H). Select "Done" to finalize your timer.

You can turn your timer on or off to accommodate changes to your regular schedule. Slide the on/off selector on the Timer homepage next to the desired timer to activate or deactivate the time based control.







LuXout Shades SPECIFICATION SUBMITTAL

Job Name: <input type="text"/>	Model Numbers: <input type="text"/>	
Job Number: <input type="text"/>	<input type="text"/>	<input type="text"/>

INSTRUCTIONS

LuXout Shades Pulse Hub & App LED Indication & Troubleshooting



Color	Response	Status
	Flashes Twice Continuous Flashing Flashes Three Times	Power On Wi-Fi Hub is in pairing mode Wi-Fi Hub has been reset for manual configuration
	On	App is connected to Wi-Fi Hub
	Continuous Flashing Blue To Purple	Wi-Fi Hub is connected to Wi-Fi router (no cloud connection)
	1 Flash Every 5 Seconds	Wi-Fi Hub is connected to cloud server and is in stand-by mode
	Continuous Flashing	Wi-Fi Hub is not connected to Wi-Fi and is actively searching for a Wi-Fi signal
	Flashing	Wi-Fi Hub's firmware is being updated

TROUBLESHOOTING:

The following scenarios are common issues that may cause connectivity problems during the Wi-Fi Hub pairing process. If you cannot achieve success connecting the Wi-Fi Hub to your network, please reference the below most common pairing roadblocks.

I CANNOT CONNECT TO MY HIDDEN WI-FI NETWORK

LuXout Shades Wi-Fi Hub does not currently support pairing with hidden networks. To connect to a hidden network, you will need to unhide the network. Once the network pairing process is complete you can re-hide the network and the Wi-Fi Hub will work without issue.

LuXout Shades SPECIFICATION SUBMITTAL

Job Name:	Model Numbers:	
<input type="text"/>	<input type="text"/>	<input type="text"/>
Job Number:	<input type="text"/>	<input type="text"/>

INSTRUCTIONS

LuXout Shades Pulse Hub & App

Troubleshooting



I HAVE MULTIPLE ACCESS POINTS AND CANNOT COMPLETE THE PAIRING PROCESS

If you have multiple wireless access points we recommend that you turn off all but one to complete the network pairing process. Once this is complete you can turn on all of the wireless access points and the Wi-Fi Hub will work without issue.

I CANNOT CONNECT TO MY 5GHZ WI-FI NETWORK

LuXout Shades Wi-Fi Hub does not currently support operation over a 5GHz network. It operates on a 2.4GHz network. Most routers are dual band and can support both network configurations. Please make sure that the 2.4GHz band is turned on in your wireless router's settings.

NETWORK SECURITY SETTINGS ARE INTERFERING WITH THE SETUP PROCESS

Some companies or large corporate offices have network security settings more advanced than the typical homeowner. If you are setting up in this environment please consult your network administrator. It may be necessary to enable device-to-device communication. One solution is to use a device with a mobile data connection available in the background to complete the set-up process.

MY WI-FI BRIDGE IS NOT CONSISTENTLY WORKING

There are many things that can interfere with the radio communication that the Wi-Fi Hub uses. Try positioning the Wi-Fi Hub in a different location and/or closer to the shade to improve performance. Due to varying levels of interference it may be necessary to purchase additional Wi-Fi Hubs to extend the coverage throughout your location.

IF YOU STILL CANNOT PAIR THE WI-FI HUB WITH YOUR WI-FI NETWORK:

Please contact 800.817.1204 or info@LuXout.com for further customer assistance.

LuXout Shades SPECIFICATION SUBMITTAL

Job Name:	Model Numbers:	
<input type="text"/>	<input type="text"/>	<input type="text"/>
Job Number:	<input type="text"/>	<input type="text"/>