

DOUBLE ROLLER SHADES TECHNICAL INFORMATION

LuXout Double Roller System

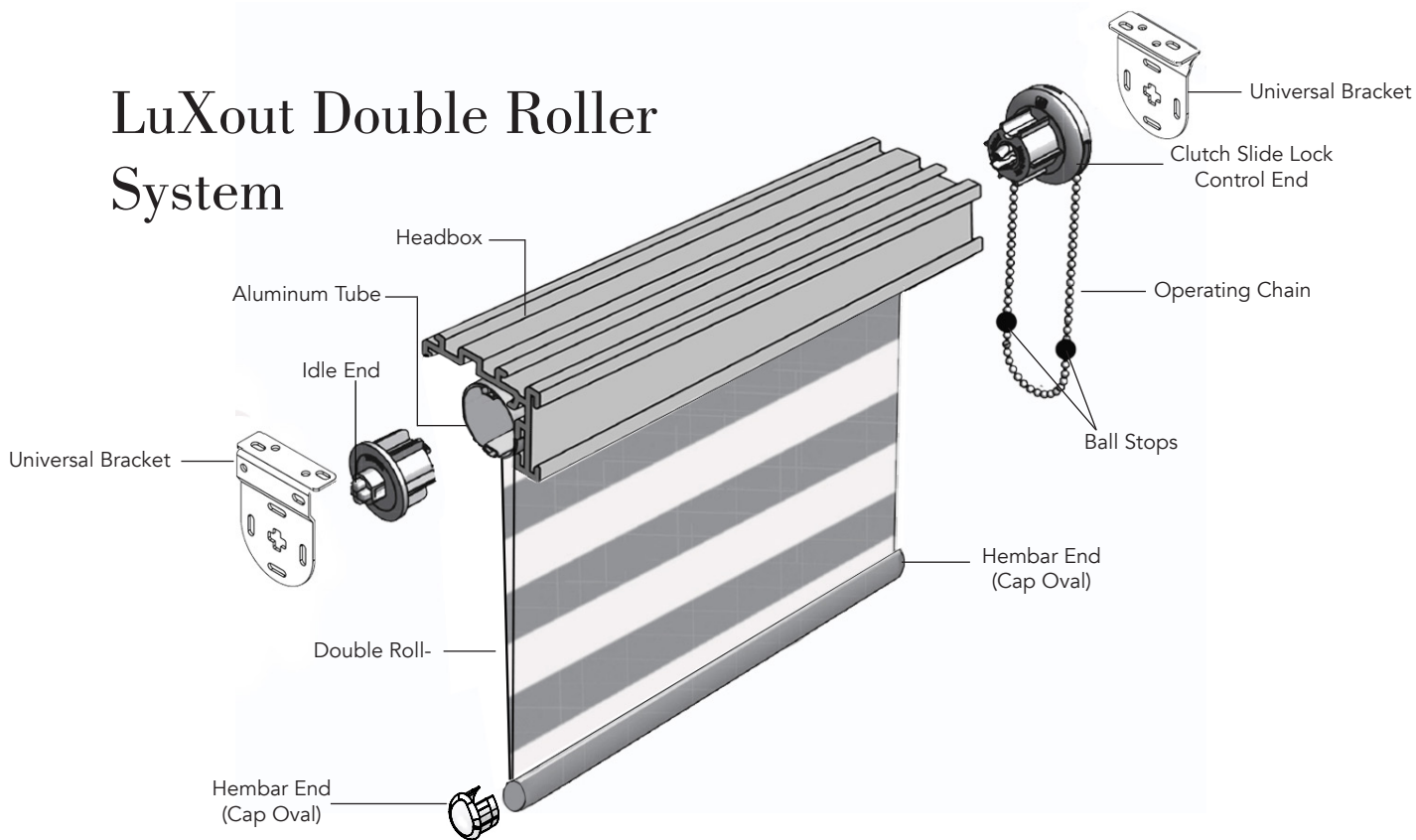

Open Cassette

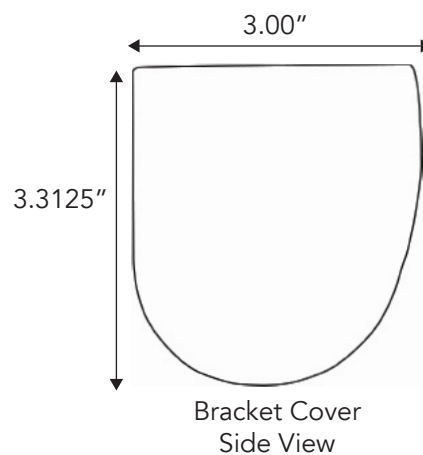
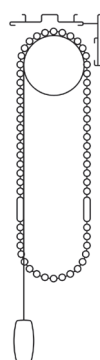
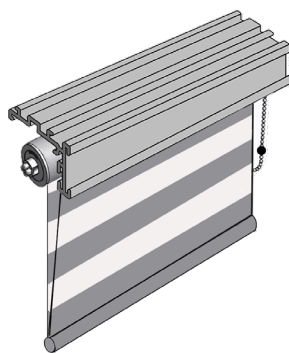
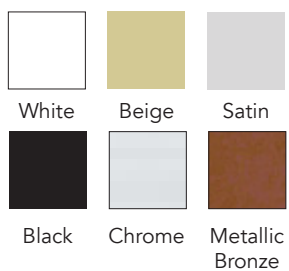

Open Fascia

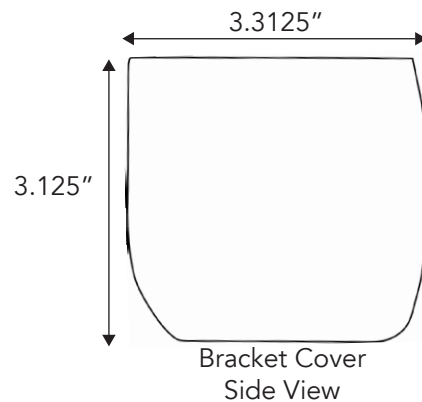
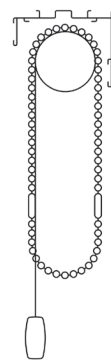
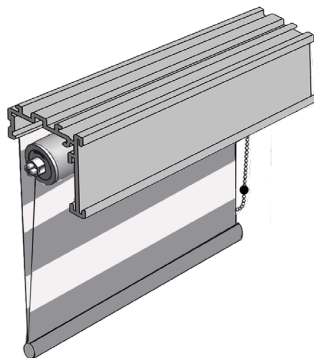
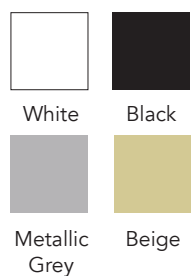

DOUBLE ROLLER SHADES FEATURES & SPECIFICATIONS

Fabric	See Double Roller Fabric Binder Resource Section for fabric colors and information.
Freight	Price is \$15 per shade for standard sizes up to 90" wide, larger sizes call for a quote.
Size Restrictions Fabric NOT Rotated	Minimum Width = 12" ordered width Maximum Width = 96" ordered Minimum Drop = 18" Maximum Drop = 108"
Outside Mount Shades	Shade is manufactured to fit width ordered as bracket-to-bracket width.
Child Safety	The Consumer Product Safety Council strongly suggests that no cords be used on any window treatment where infants and small children and pets are or could be near. We offer cordless motorized shades to avoid this issue. Corded shades, those with clutch bead chains require warning labels on the cord and hembar that are visible. Warning labels must not be removed.
Open Cassette & Open Fascia	Extruded aluminum panel that hides the clutch and the tube. Numerous headbox colors available. Color must be specified on order. Hardware will match the headbox color. Headbox brackets include end caps. See Color coordination charts on each price list.
Motorized Shades & Controls	Motor controller and power supply for low voltage wired or rechargeable battery motor. For additional motorization controls, chargers, etc. refer to the motorized shade information. Each room of shades will include one 5 Channel Controller and one charger (for rechargeable motor).
Clutch	The clutch is sized as needed for each individual shade's lifting requirement. Specify right or left side clutch. Clutch available in white (standard) beige, grey, or black depending on headbox color. See chart for options on each price page.
Brackets	Universal brackets (inside, outside or ceiling mounting) are available in white (standard) or other colors depending on headbox configuration. See Color Coordination charts on each price list.
Hembar	Fabric covered hembar is standard, exposed hembar available as an option.
Inside Mount Shades	Shade is made for brackets to be mounted inside window with a top window width equal to the size ordered. Do not take deduction for inside mount.
Chain Loop	Chain loop is available as #10 metal bead chain. Stainless steel beaded cord loop is also available. See attached color coordination chart for standard chain colors. Chain color may be specified on order.
Fabric Wrapped Headbox	Fabric can be applied to the headbox to provide a matching, finished look. Fabric is attached with a solid piece of double sided tape. If you do not want fabric on the headbox, Please note on order.