

# INSTRUCTIONS

## One Touch Wand

### Overview

#### Components for One Touch Wand Battery Operation

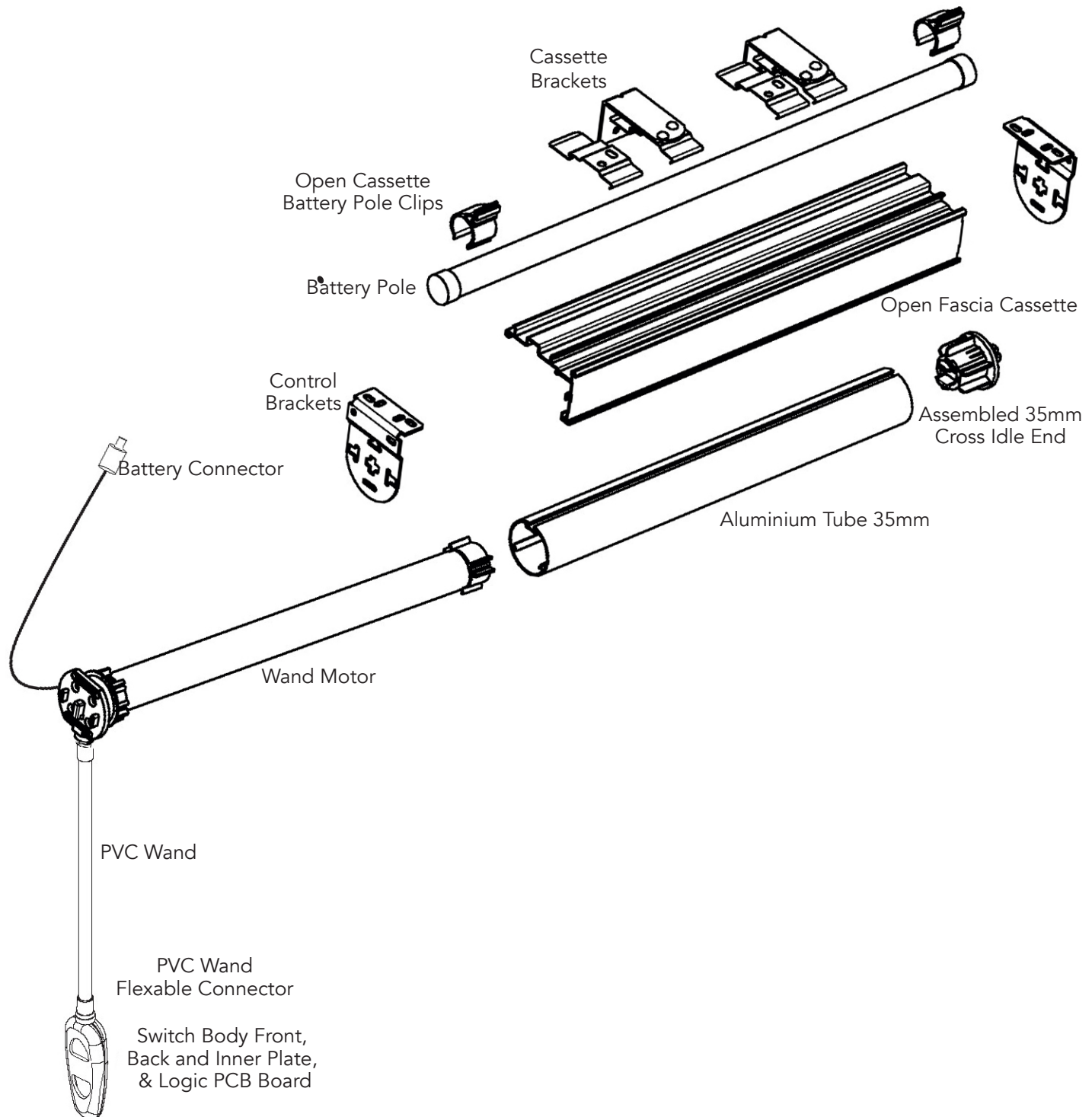

**LuXout** Shades

SPECIFICATION SUBMITTAL

Job Name:	Model Numbers:	
<input type="text"/>	<input type="text"/>	<input type="text"/>
Job Number:	<input type="text"/>	<input type="text"/>

# INSTRUCTIONS

## One Touch Wand

### Specifications

#### MOTOR SIZE

One Touch Wand - Battery Operation

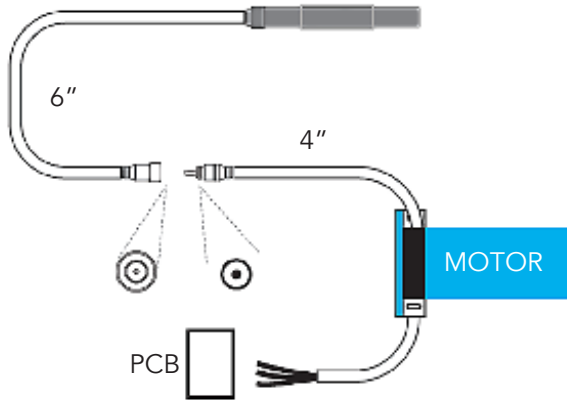
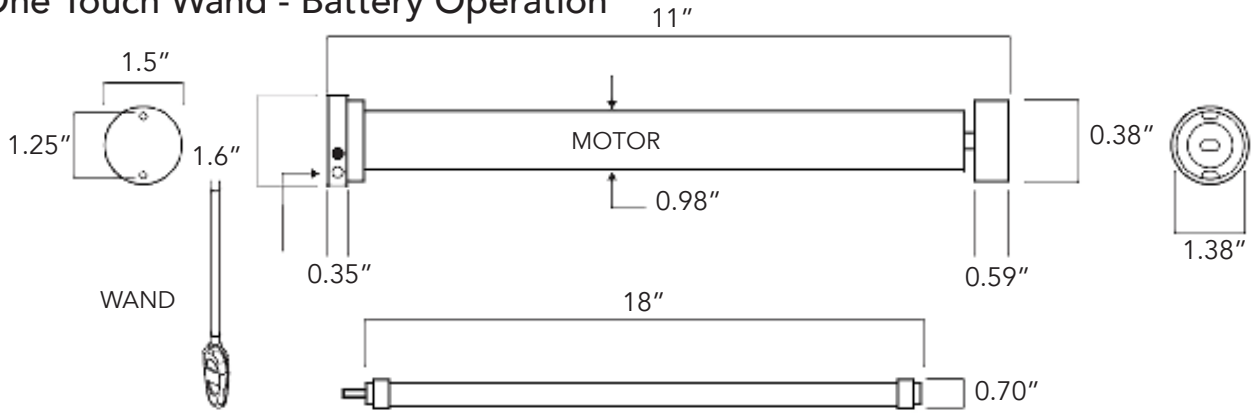

#### PARAMETERS

Rated Torque	0.7Nm
Rated RPM	34 rpm
Motor Diameter	0.98"
Rated Voltage	DC 12V
Rated Power	9.6W
Rated Current	0.8A
IP Class	IP40
Cable	3 core
Inbuilt Receiver	No

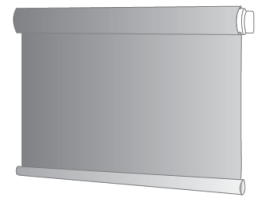

Roller Shade

Maximum recommended sizes in blue

DROP	WIDTH							
	15"	30"	36"	42"	54"	60"	66"	72"
12"	•	•	•	•	•	•	•	•
24"	•	•	•	•	•	•	•	•
36"	•	•	•	•	•	•	•	•
48"	•	•	•	•	•	•	•	•
60"	•	•	•	•	•	•	•	•
72"	•	•	•	•	•	•	•	•

#### Features:

- Electronic limits
- Compatible with standard roller brackets
- Battery life: 6 months+
- Use good quality AA Alkaline batteries (x 8)
- Minimum shade width 15" (with open cassette 18.11")
- Weight capacity 5.3 pounds
- Initial programming set in plant

LuXout Shades

#### SPECIFICATION SUBMITTAL

Job Name:	Model Numbers:	
<input type="text"/>	<input type="text"/>	<input type="text"/>
Job Number:	<input type="text"/>	<input type="text"/>

# INSTRUCTIONS

## One Touch Wand

### Adjustment Instructions

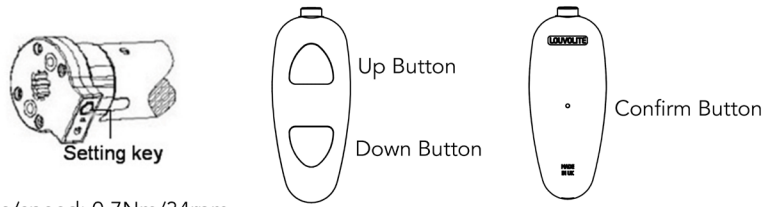

Motor Torque/speed: 0.7Nm/34rpm

- Motor is combined with a wired switch and powered by a battery wand
- The side of motor mount with SETTING button should face to you
- Please replace batteries when the motor alarm sounds

Operation	Step	Action	Result	Illustration
	1	Press red button on the motor	Until motor beeps x 6	
<b>Check the motor direction</b>		Check the direction of the motor by pressing <b>UP</b> or <b>DOWN</b> on the switch	If correct go to set up lower stop steps 2-4, if incorrect go to change motor direction step 14	
<b>Set-up lower Stop</b>	2	Press <b>DOWN</b> button	Motor rolls down	
	3	When motor gets close to the required lower limit, press <b>STOP</b> button	Motor stops	
	4	Press <b>DOWN</b> button <b>AGAIN</b>	Motor runs step by step to adjust lower limit accurately	
	5	Press <b>CONFIRM</b> button	The motor beeps x 1, and the lower limit has been set.	
<b>Set-up upper stop</b>	6	Press <b>UP</b> button	Motor rolls up	
	7	When motor gets close to the required upper limit, press <b>STOP</b> button.	Motor stops	
	8	Press <b>UP</b> button <b>AGAIN</b>	Motor runs step by step to set upper limit accurately	
	9	Press <b>CONFIRM</b> button	The motor beeps x 1 and the upper limit has been set.	

LuXout Shades

SPECIFICATION SUBMITTAL

Job Name:	Model Numbers:	
<input type="text"/>	<input type="text"/>	<input type="text"/>
Job Number:	<input type="text"/>	<input type="text"/>

# INSTRUCTIONS

## One Touch Wand Adjustment Instructions

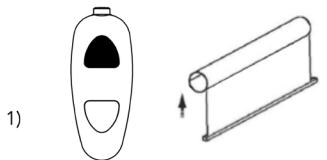
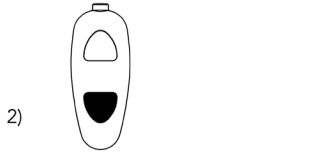
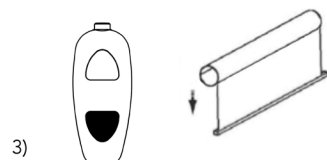
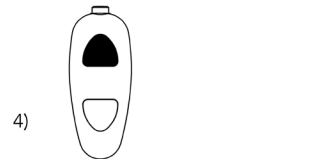
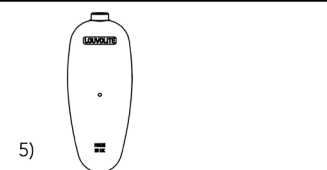
Operation	Step	Action	Result	Illustration
To raise blind	10	Press <b>UP</b> button	Blind rolls up to its upper limit.	1) 
	11	Press <b>DOWN</b> button	Blind stops at desired point.	2) 
To lower blind	12	Press <b>DOWN</b> button	Blind rolls down to its lower limit.	3) 
	13	Press <b>UP</b>	Blind stops at desired point	4) 
To change direction of motor	14	Press <b>CONFIRM</b> x 6	Beeps x 2 Blind will change direction	5) 
Reset		Go through steps 1-9	Enter jog mode press confirm for 3/4 seconds beeps x 4. <b>Short press</b> - blinds jogs. <b>Long press</b> - blind operates to top/bottom stop. Exit jog mode (same as above).	

Job Name:	Model Numbers:	
<input type="text"/>	<input type="text"/>	<input type="text"/>
Job Number:	<input type="text"/>	<input type="text"/>