

INSTRUCTIONS

MULTI-CHANNEL CONTROLLER OVERVIEW

Multi-Channel Option



Level Control



Touch Sensitive



433 MHz

About The Controller

The LuXout Shades Multi-Channel Controller features a contemporary design with touch sensitive controls. Each battery and plug-in shade from LuXout Shades will come preprogrammed from the factory. The pre-programming assures the remote is paired with the shade, the upper and lower operation limits are set, the remote is locked and the unnecessary channels are hidden for ease of use. (15 available)

Features:

- Up to fifteen channel capacity.
- Touch sensitive buttons.
- Slim Magnetic wall mount.
- LCD display.
- Hide unused channel function.
- Levelling control.
- Individual/group control.

Package Contents

- Remote
- Magnetic holder & fixing screws
- Instruction Manual
- 3V - CR2450 Battery



SPECIFICATION SUBMITTAL

JOB NAME	MODEL NUMBERS		
<input type="text"/>	<input type="text"/>	<input type="text"/>	<input type="text"/>
JOB NUMBER	<input type="text"/>	<input type="text"/>	<input type="text"/>



INSTRUCTIONS

MULTI-CHANNEL CONTROLLER OVERVIEW



Multi-Channel Overview

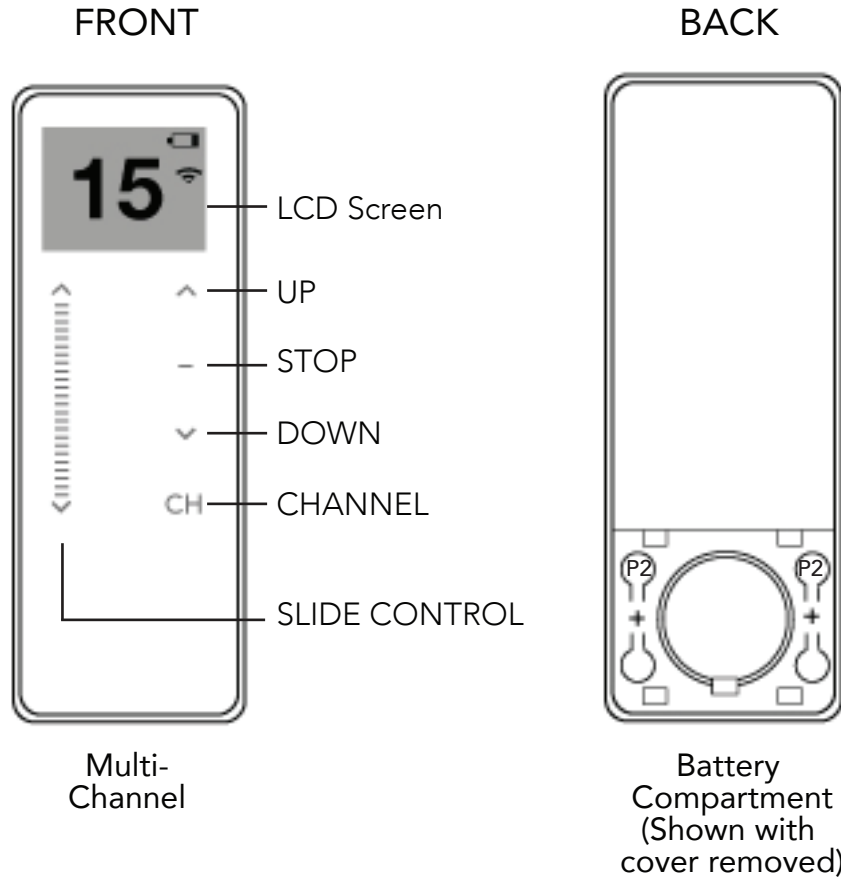

TECHNICAL SPECIFICATIONS	
Voltage	3V (CR2450)
Frequency	433.92 MHz
Transmitting Power	10 milliwatt
Ambient Operating Temperature	-10°C - 50°C
Transmission Distance	Up to 600 feet (open spaces)
Battery	CR2450



SPECIFICATION SUBMITTAL

JOB NAME	MODEL NUMBERS		
<input style="width: 100%;" type="text"/>	<input style="width: 25%;" type="text"/>	<input style="width: 25%;" type="text"/>	<input style="width: 25%;" type="text"/>
JOB NUMBER	<input style="width: 25%;" type="text"/>	<input style="width: 25%;" type="text"/>	<input style="width: 25%;" type="text"/>



INSTRUCTIONS

MULTI-CHANNEL CONTROLLER OVERVIEW

Install Wall Mount Holder

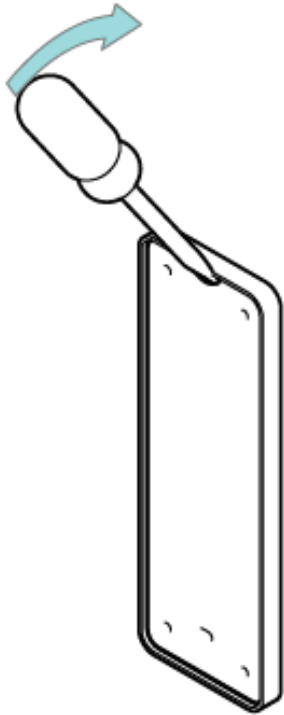

Remove cover from base by prying with flat head screwdriver

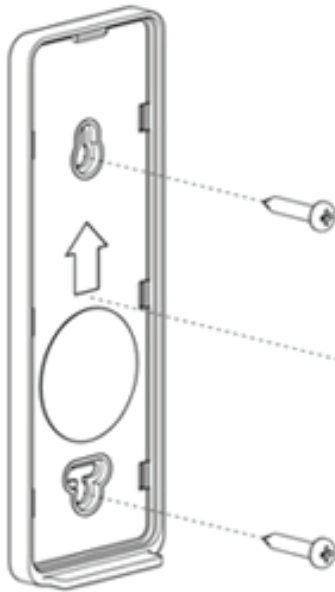

Use supplied fasteners to attach base to desired surface as shown in figure

Assure screwdriver slot is facing up or the controller will not be held in place securely

Replace cover by pressing snap latches into place



SPECIFICATION SUBMITTAL

JOB NAME	MODEL NUMBERS		
JOB NUMBER			



INSTRUCTIONS

MULTI-CHANNEL CONTROLLER OVERVIEW

Install or Replace Controller Battery

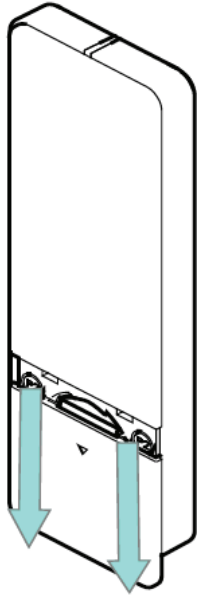

Remove cover from controller: with 2 fingers placed in upper area of cover, press gently in and down to disengage cover and slide down to remove

Install battery with positive (+) side facing up

Replace cover by reversing step 1

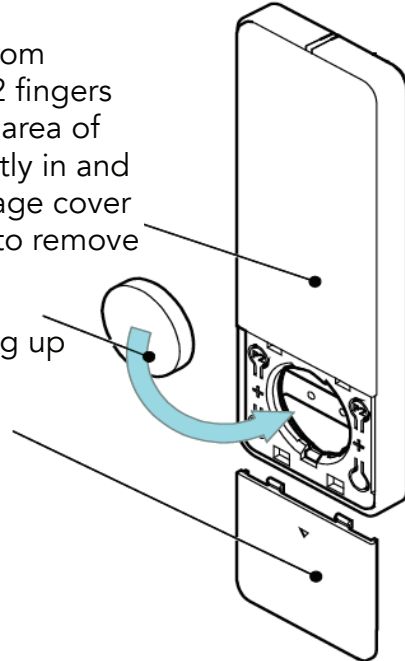

Unlock/Lock Controller - Limit Setting

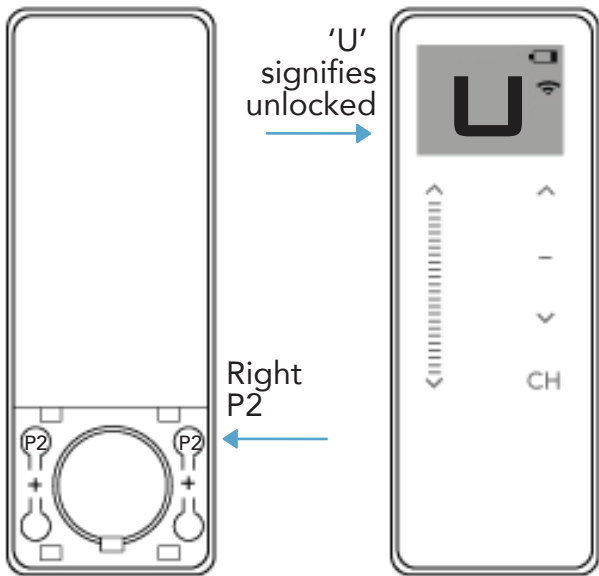

'U' signifies unlocked

Right P2

If limits need adjusting, follow the instructions below to unlock the controller for limit setting:

- Unlock the limit setting tool by pressing the right **P2** button on the back of the controller (remove cover to expose the button)
- Press and hold the button until the LED display shows a flashing "U", then release.
- You will be required to set the controller back in to "limit locking mode" once final adjustments have been made. Simply repeat the above step until a flashing "L" shows on the display ("U" for unlocked, "L" for locked).



SPECIFICATION SUBMITTAL

JOB NAME	MODEL NUMBERS		
<input type="text"/>	<input type="text"/>	<input type="text"/>	<input type="text"/>
JOB NUMBER			
<input type="text"/>	<input type="text"/>	<input type="text"/>	<input type="text"/>



INSTRUCTIONS

MULTI-CHANNEL CONTROLLER SLEEP MODE



It is necessary to "Wake" the motor before operation and setup. (Rechargeable battery motors only)

Each battery & plug-in motor comes preprogrammed from LuXout Shades. Upon leaving the factory the motor is placed into "Sleep Mode" to avoid accidental operation during shipping.

To "Wake" the motor and exit Sleep Mode, assure the motor is installed and secured in the mounting hardware.

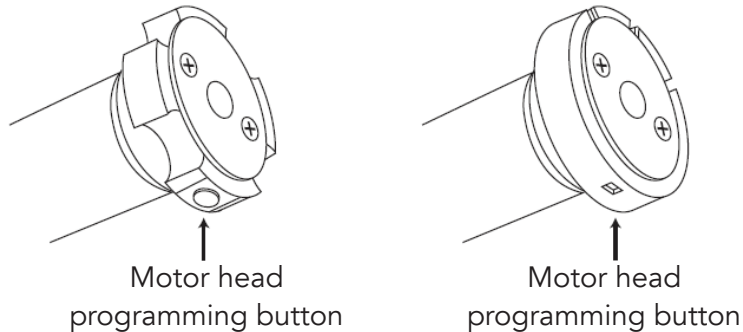

After the motor is installed in the brackets, press and hold the programming button on the motor head until the motor jogs up and down once. It is now no longer in "Sleep Mode" and ready for further setup.

*** Warning, if you press and release the programming button quickly, the motor will lower to its lower limit. Be mindful of this during the install process.**

SLEEP

If required, to place the motor back into "Sleep Mode" press and hold the programming button for a period of 6 seconds. Release the button when the motor has jogged up and down twice. The motor will beep twice to signify "Sleep Mode" has been activated.

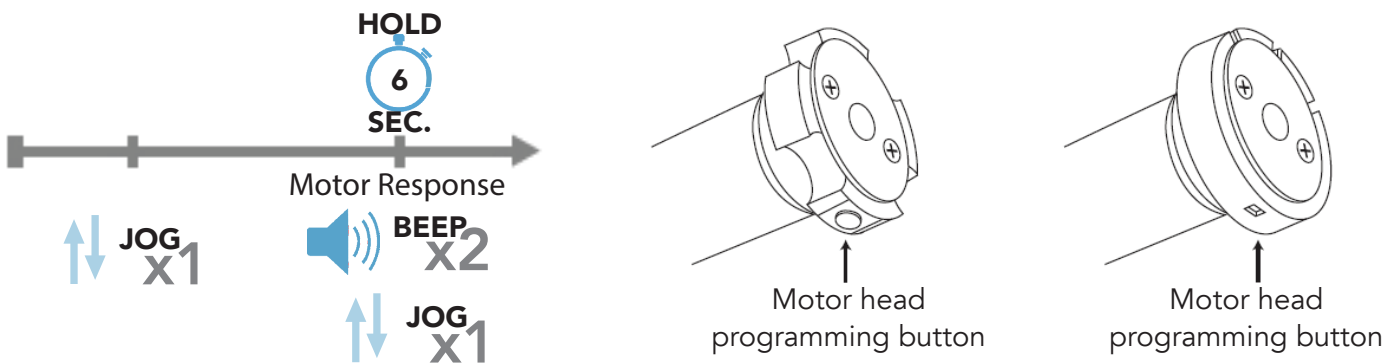

SPECIFICATION SUBMITTAL

JOB NAME	MODEL NUMBERS		
<input type="text"/>	<input type="text"/>	<input type="text"/>	<input type="text"/>
JOB NUMBER			
<input type="text"/>	<input type="text"/>	<input type="text"/>	<input type="text"/>



INSTRUCTIONS

MULTI-CHANNEL CONTROLLER REMOTE & MOTOR PAIRING

Each battery & plug-in motor will come preprogrammed from LuXout Shades. The preprogramming assures the remote is paired with the motor, the upper and lower operation limits are set, the remote is locked and the unnecessary channels are hidden for ease of use (15 available).

Follow the below steps to select the remote channel you want to pair with the motor(s) if required at a later date.

Select Channel

A). Press any button to wake controller.

HOLD CH (1 second)
LCD screen will flash to confirm.

B). Within 4 seconds Press **UP** or **DOWN** to select desired channel.

C). Press **STOP** to confirm selection OR controller will auto confirm after 4 seconds.

Pairing/Removing Motor From A Specific Channel

Press and **HOLD** programming button on motor head for 2 seconds.

Motor Response

HOLD 2 SEC. **LONG BEEP X1**
JOG X1

Within 4 sec of activating pairing mode, Press & **Hold STOP.**

Motor Response

HOLD 2 SEC. **BEEP X3**
JOG X2

If you do not pair the controller in time the motor pairing sequence will time out, repeat the above steps assuring to press and hold the STOP button within 4 seconds of the motor jog.



SPECIFICATION SUBMITTAL

JOB NAME	MODEL NUMBERS		
JOB NUMBER			



INSTRUCTIONS

MULTI-CHANNEL CONTROLLER REVERSE MOTOR DIRECTION



To reverse the motor direction at any time, use the motor operation method shown below.

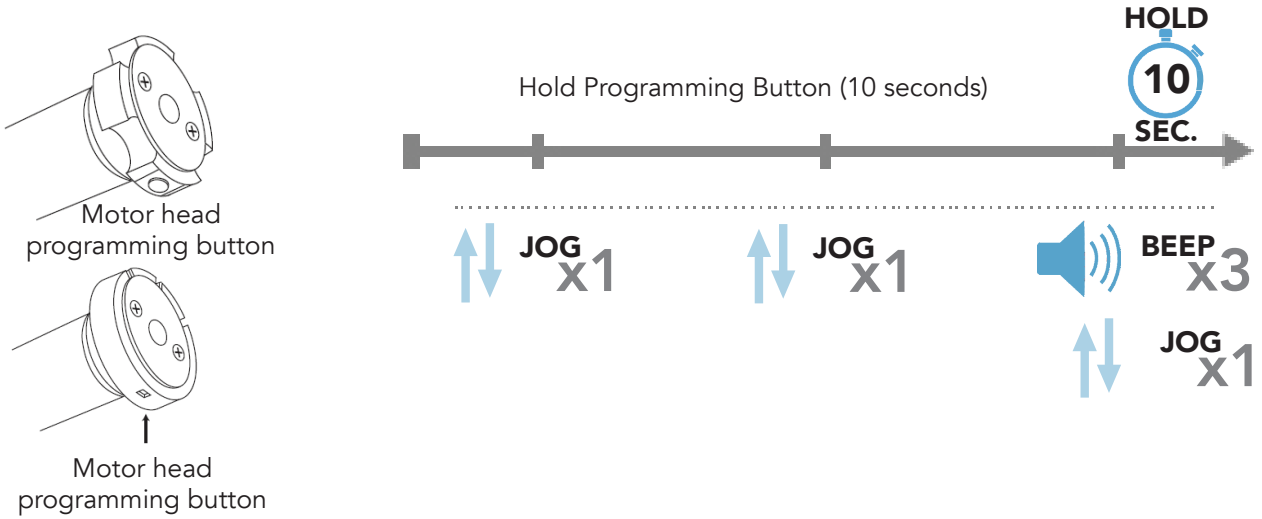

SPECIFICATION SUBMITTAL

JOB NAME	MODEL NUMBERS		
<input type="text"/>	<input type="text"/>	<input type="text"/>	<input type="text"/>
JOB NUMBER	<input type="text"/>	<input type="text"/>	<input type="text"/>
<input type="text"/>	<input type="text"/>	<input type="text"/>	<input type="text"/>



INSTRUCTIONS

MULTI-CHANNEL CONTROLLER MIRRORING CONTROLLERS



1). Select Channel On Existing Controller To Be Copied

Select channel on existing controller to be copied. Select channel on new controller where existing channel will be copied.

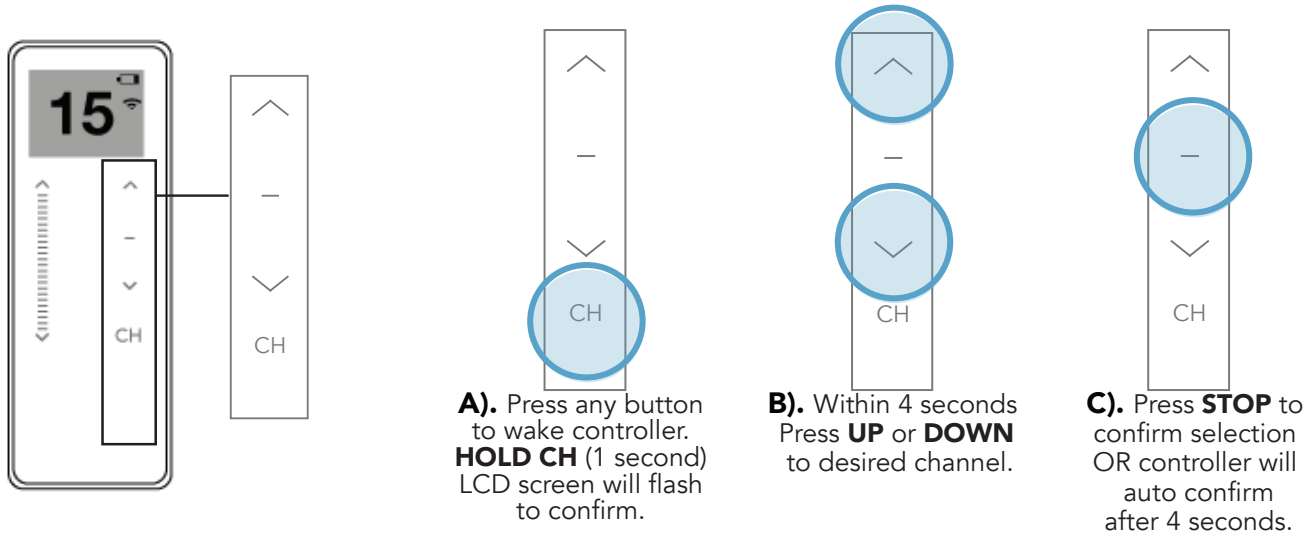

2). Add/Remove Controller Using An Existing Controller

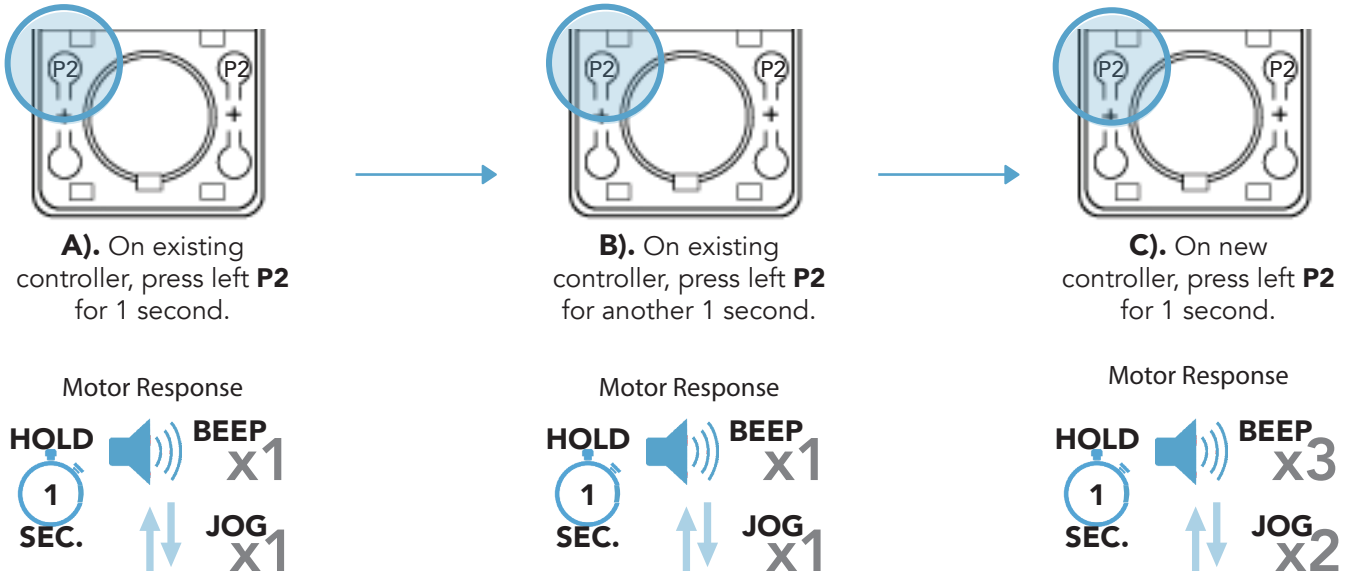

SPECIFICATION SUBMITTAL

JOB NAME	MODEL NUMBERS		
<input type="text"/>	<input type="text"/>	<input type="text"/>	<input type="text"/>
JOB NUMBER			
<input type="text"/>	<input type="text"/>	<input type="text"/>	<input type="text"/>



INSTRUCTIONS

MULTI-CHANNEL CONTROLLER ADJUSTING LIMITS

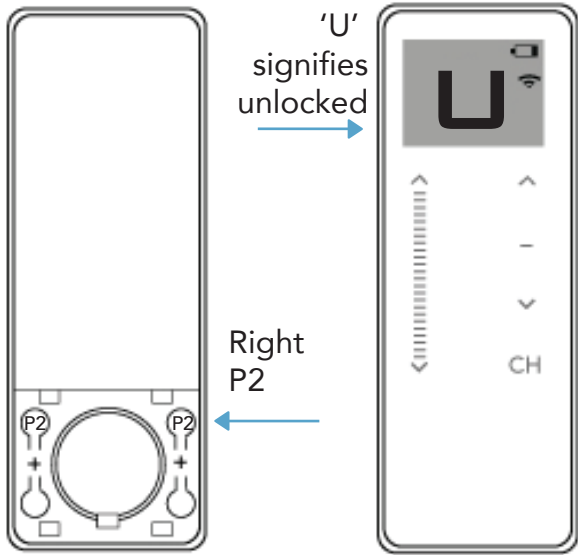

If limits need adjusting, follow the instructions below to unlock the controller for limit setting:

- Unlock the limit setting tool by pressing the right **P2** button on the back of the controller (remove cover to expose the button)
- Press and hold the button until the LED display shows a flashing "U", then release.
- You will be required to set the controller back in to "limit locking mode" once final adjustments have been made. Simply repeat the above step until a flashing "L" shows on the display ("U" for unlocked, "L" for locked).

Adjusting Upper Limits

Delete Top Limit
Press **UP & STOP**
5 seconds

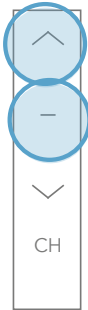

Motor Response
HOLD 5 SEC. **BEEP** X1
JOG X1

Move the shade to the new desired position to be set as limit.

IMPORTANT!! Stop the shade before traveling past the desired lower limit.

Set Top Limit
Press **UP & STOP**
5 seconds

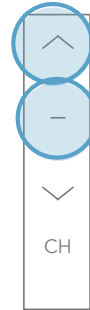

Motor Response
HOLD 5 SEC. **BEEP** X3
JOG X2



SPECIFICATION SUBMITTAL

JOB NAME	MODEL NUMBERS		
<input type="text"/>	<input type="text"/>	<input type="text"/>	<input type="text"/>
JOB NUMBER			
<input type="text"/>	<input type="text"/>	<input type="text"/>	<input type="text"/>



INSTRUCTIONS

MULTI-CHANNEL CONTROLLER ADJUSTING LIMITS



Adjusting Lower Limits

Delete Lower Limit
Press **DOWN & STOP**
5 seconds

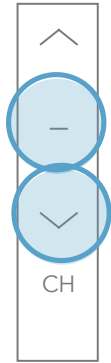

Move the shade to the new desired position to be set as limit.
IMPORTANT!! Stop the shade before traveling past the desired lower limit.

Set Lower Limit
Press **DOWN & STOP**
5 seconds



Motor Response

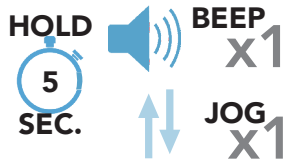

Motor Response

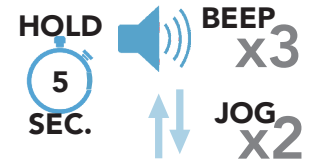

!!WARNING!! - Move shade in short increments by pressing the UP/DOWN button in 1 second intervals (pressing the UP/DOWN button for more than 3 seconds may send the shade past desired upper/lower limit and may result in damage to the product). Once you have reached the desired upper/lower limit, you can adjust the limit with either the UP and DOWN buttons. (remember to adjust in short increments!)



SPECIFICATION SUBMITTAL

JOB NAME	MODEL NUMBERS		
JOB NUMBER			



INSTRUCTIONS

MULTI-CHANNEL CONTROLLER HIDE/UNHIDE CONTROLLER CHANNELS



Hide/Unhide Controller Channels

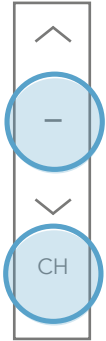

A). Press & Hold
STOP + CH

Controller Response
LCD screen flashes
"15" which defaults
controller control to 15
visible channels

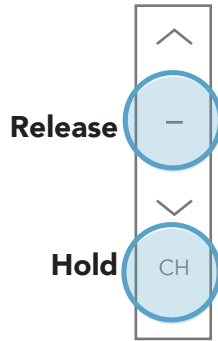

B). Release only **STOP**

Keep **CH** pressed for
the entire procedure.

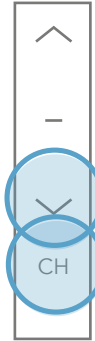

C). Press **UP** or **DOWN**
to select number of
active channels.

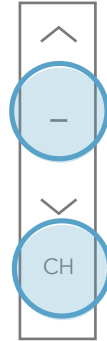

D). Press **STOP**, then
release **CH** to
confirm.

JOB NAME <input type="text"/>	MODEL NUMBERS <input type="text"/> <input type="text"/> <input type="text"/>		
JOB NUMBER <input type="text"/>	<input type="text"/>	<input type="text"/>	<input type="text"/>

INSTRUCTIONS

MULTI-CHANNEL CONTROLLER FAVORITE POSITIONS

Follow the below steps to set a favorite position. The favorite position is used to set a custom stopping point between the upper and lower limits. (1 favorite position per shade motor).

To set a favorite position for a shade motor, move to the desired position and press the STOP button to pause the drive operation.

Setting Favorite

A). Press **UP** or **DOWN** to move shade to desired favorite position.

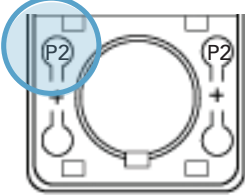

B). Press left **P2**.



C). Press **STOP**.



D). Press **STOP** again.

Motor Response

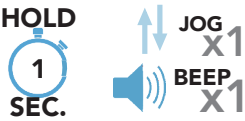

Motor Response

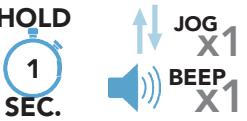

Motor Response

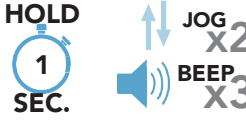

* Press **STOP** (3 seconds) to move shade to the Favorite Position from any location.
 * Repeat Steps A - D for any additional motors.

Follow the below steps to set a favorite position. The favorite position is used to set a custom stopping point between the upper and lower limits. (1 favorite position per shade motor).

Delete Favorite

A). Press **STOP** (3 seconds) to send the shade to the stored favorite position.

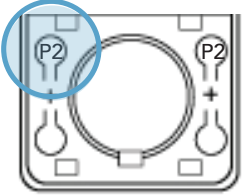

B). Press left **P2**.



C). Press **STOP**.



D). Press **STOP** again.

Motor Response

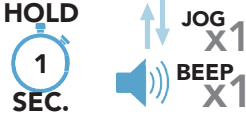

Motor Response



Motor Response



JOB NAME	MODEL NUMBERS		
JOB NUMBER			

INSTRUCTIONS

MULTI-CHANNEL CONTROLLER GROUP CONTROL

Each battery & plug-in motor will come preprogrammed from LuXout Shades. If multiple motors are paired to the same 15 channel remote, the 0 channel is the default channel to control all motors at once. Follow the steps below to group motors on a specific channel for simultaneous control.

To custom define a channel to control multiple motors, pairing in groups can be executed. This will allow you to operate a series of motors in unison without needing to change channels. Each motor to be grouped must be paired with the remote on its own channel prior to grouping.

1). Select Channel To Be Paired As A Group

A). Press any button to wake controller. **HOLD CH** (1 second) LCD screen will flash to confirm.

B). Within 4 seconds Press **UP** or **DOWN** to desired channel.

C). Press **STOP** to confirm selection OR controller will auto confirm after 4 seconds.

2). Pairing Controller to Motor

Repeat for all motors to be added or removed from your desired group channel.

A). Activate Pairing Mode on Motor

Motor head programming button

Motor head programming button

Press and **HOLD** programming button on motor head for 2 seconds.

Motor Response

HOLD 2 SEC.

LONG BEEP X1

JOG X1



SPECIFICATION SUBMITTAL

JOB NAME	MODEL NUMBERS		
JOB NUMBER			



INSTRUCTIONS

MULTI-CHANNEL CONTROLLER GROUP CONTROL



B). Pairing Controller

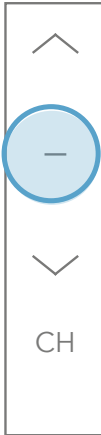

Within 4 sec of activating pairing mode, Press & **HOLD STOP**.

Motor Response

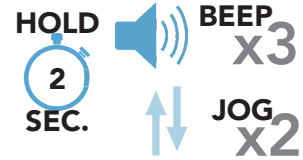

If you do not pair the controller in time the motor pairing sequence will time out, repeat the above steps assuring to press and HOLD the STOP button within 4 seconds of the motor jog.

3). Adjusting limits of an individual shade paired on a group channel

To adjust the limits of a shade that is currently grouped on a channel with other shades, it is necessary to place all shades, with the exception of the shade to be adjusted, to sleep.

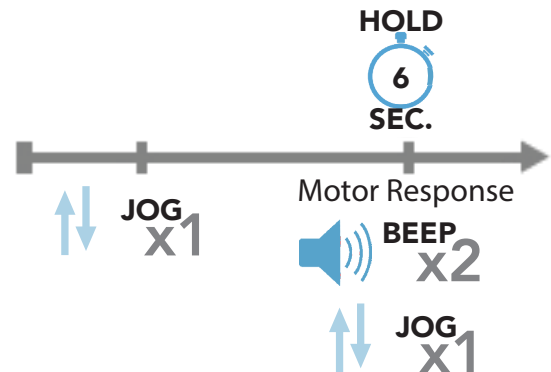
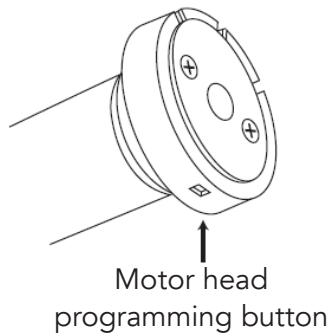
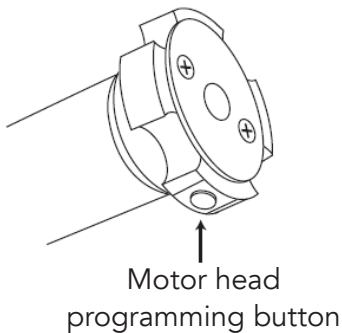

Once all other shades have been put to sleep, unlock controller by pressing and **HOLDING** the upper left **P2** button under the battery cover until "U" is displayed on the LCD screen. Adjust the shade limits as outlined below:



SPECIFICATION SUBMITTAL

JOB NAME	MODEL NUMBERS		
JOB NUMBER			



INSTRUCTIONS

MULTI-CHANNEL CONTROLLER GROUP CONTROL

Adjusting Upper Limit

Delete Top Limit
Press **UP & STOP**
5 seconds

Set Top Limit
Press **UP & STOP**
5 seconds



Adjusting Lower Limit

Delete Lower Limit
Press **DOWN & STOP**
5 seconds

Set Lower Limit
Press **DOWN & STOP**
5 seconds

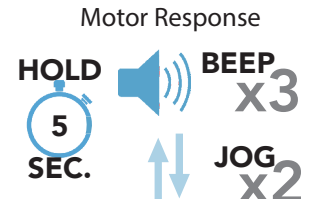
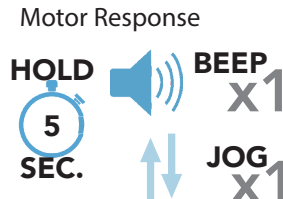
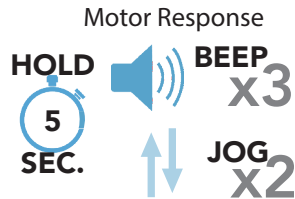
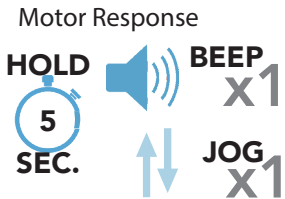
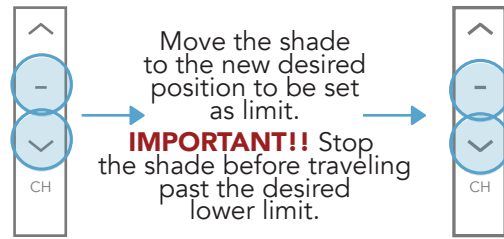

!!WARNING!! - Move shade in short increments by pressing the UP/DOWN button in 1 second intervals (pressing the UP/DOWN button for more than 3 seconds may send the shade past desired upper/lower limit and may result in damage to the product). Once you have reached the desired upper/lower limit, you can adjust the limit with either the UP and DOWN buttons. (remember to adjust in short increments!)

Once the limits have been adjusted as desired, return the controller to "L" mode by pressing and holding the upper left P2 button under the battery cover. The other grouped motors can now be taken out of sleep mode by holding the programming button for 6 seconds.



SPECIFICATION SUBMITTAL

JOB NAME	MODEL NUMBERS		
JOB NUMBER			



INSTRUCTIONS

MULTI-CHANNEL CONTROLLER RESET TO FACTORY SETTINGS

Each battery & plug-in motor will come preprogrammed from LuXout Shades. The preprogramming assures the remote is paired with the motor, the upper and lower operation limits are set, the remote is locked and the unnecessary channels are hidden for ease of use (15 available).

Follow the below steps to reset the motor to factory settings and delete all limits.

To reset the shade motor to factory settings with no stored limits locate the P1 button on the motor head. **HOLD** the programming button for 14 seconds (4 motor jogs). External battery motors will jog 3 times for a full factory reset.

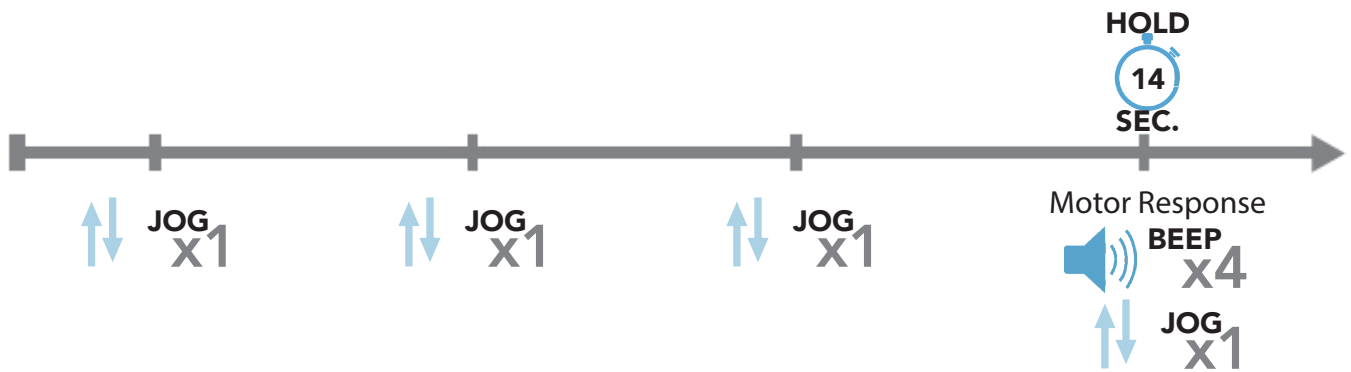
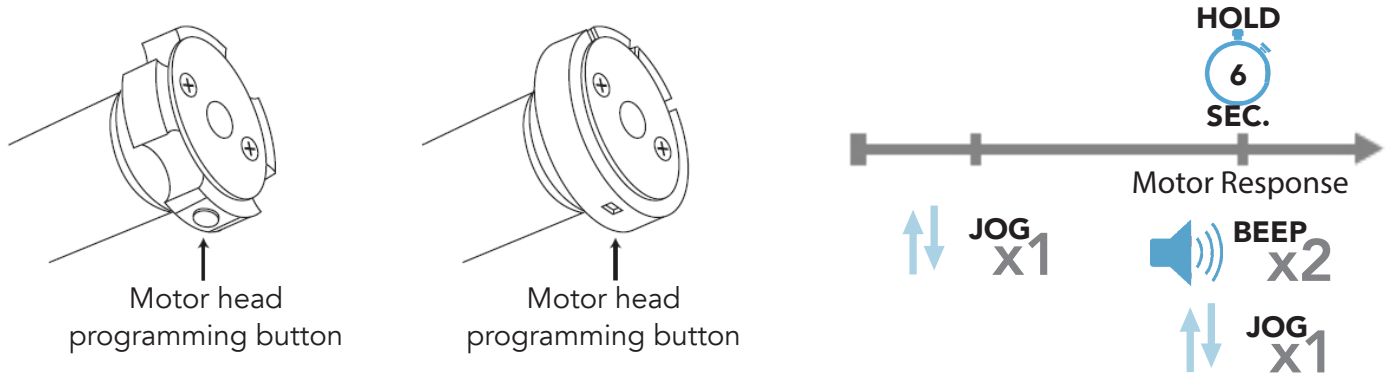

The motor will jog 4 times before the reset is complete. The P1 button must be held the entire time. 4 beeps confirm the factory reset is complete.

Refer to the Initial Setup Programming section to program a shade after a factory reset.

JOB NAME <input style="width: 95%; height: 20px;" type="text"/>	MODEL NUMBERS <input style="width: 25%; height: 20px;" type="text"/> <input style="width: 25%; height: 20px;" type="text"/> <input style="width: 25%; height: 20px;" type="text"/>		
JOB NUMBER <input style="width: 95%; height: 20px;" type="text"/>	<input style="width: 25%; height: 20px;" type="text"/> <input style="width: 25%; height: 20px;" type="text"/> <input style="width: 25%; height: 20px;" type="text"/>		

INSTRUCTIONS

MULTI-CHANNEL CONTROLLER ADJUSTING MOTOR SPEED



Follow the below steps to adjust the motor speed (ONLY APPLICABLE TO DC MOTORS).
To adjust the motor speed a remote must be paired.

To enter speed adjustment mode remove the rear battery cover of the remote. Press and **HOLD** the left **P2** button for 2 seconds. the motor will perform one up and down jog and beep once.

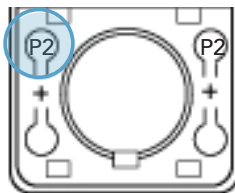

Motor Response

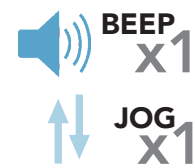

To Increase Speed

IMPORTANT

If motor does not react to speed adjustment, the maximum or minimum speed has already been reached.



Press **UP**.

Motor Response

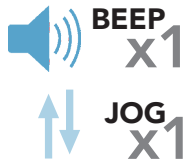

Repeat

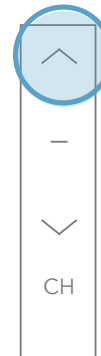

Press **UP**.

Motor Response

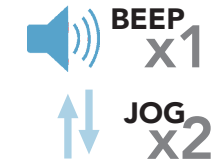

To Decrease Speed

IMPORTANT

If motor does not react to speed adjustment, the maximum or minimum speed has already been reached.

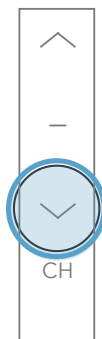

Press **DOWN**.

Motor Response

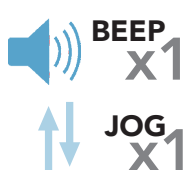

Repeat

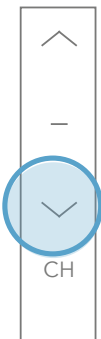

Press **DOWN**.

Motor Response



SPECIFICATION SUBMITTAL

JOB NAME	MODEL NUMBERS		
JOB NUMBER			



INSTRUCTIONS

MULTI-CHANNEL CONTROLLER TROUBLESHOOTING



Issue	Cause	Solution
Motor is not responding	Controller battery is discharged	Replace battery
	Battery is inserted incorrectly	Check battery polarity
	Radio interference / Shielding	Ensure controller is positioned away from metal objects and that aerial on motor or receiver is kept straight and away from metal
	Receiver distance is too far from controller	Move controller to a closer position
	Power failure	Check power supply to motor is connected & active
	Incorrect wiring	Check wiring is connected correctly (refer to motor installation instructions)
Cannot set limits on a single Motor (multiple motors respond)	Using 'group' channels to adjust motor limits	Always reserve an individual channel for programming functions. System Best Practice - Provide an extra Multi-Channel Controller in multi motor projects that provide individual control for each motor for programming purposes.



SPECIFICATION SUBMITTAL

JOB NAME	MODEL NUMBERS		
JOB NUMBER			

